

SUITE UNDERWAY

- SUITE 920
- FLOOR 9
- 3,935 RSF
- MOVE-IN JANUARY 2021

Suite Features

- Corner suite with excellent light & views
- 2 conference rooms
- 3 phone rooms plus 2 Phone Booths
- Storage / IDF
- Formal reception lounge
- 3 private offices
- Break room with appliances
- 20 Sit/stand desks in open work area

Studio Private Amenities

- Fully furnished with high-end furniture & appliances
- Wired for internet & WiFi
- Access control
- All utilities included
- Maintenance & daily cleaning
- Remote account manager
- Add-on custom services

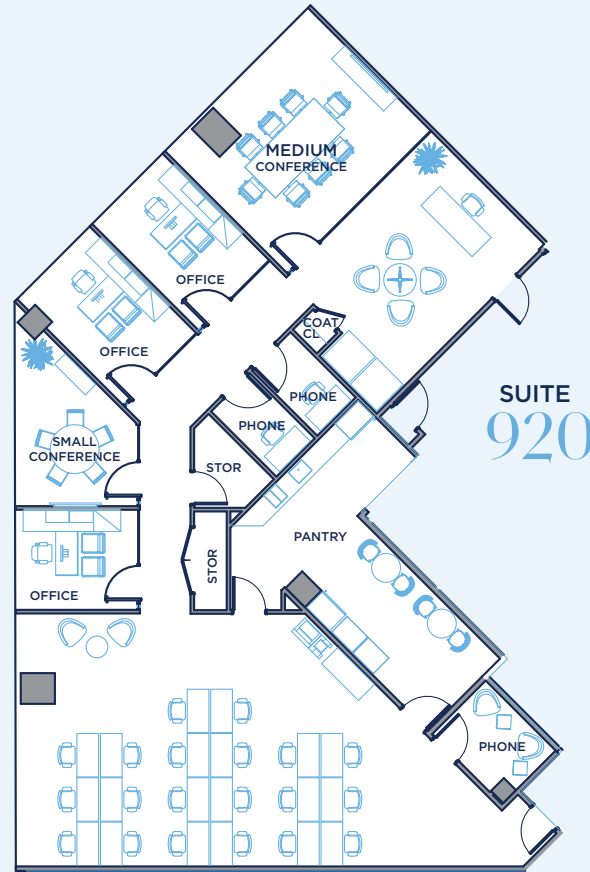

SUITE
 920



PATRICK DEVINGER
 415.273.7921
 pdevinger@tishmanspeyer.com

MATT MULRY
 650.296.3775
 mmulry@tishmanspeyer.com



TISHMAN SPEYER